

# 2600 D

Cooker hood

Operating and Installation Instructions

# Contents

Safety instructions .....	2
Description of the cooker hood .....	3
Using the cooker hood .....	4
Maintenance and cleaning .....	6
What to do if .....	8
Service and Spare Parts .....	9
Customer Care .....	9
Guarantee Conditions .....	10
Technical data .....	11
Installation .....	12



## Safety instructions

These warnings are provided in the interest of your safety. Ensure that you understand them all before installing or using the appliance. Your safety is of paramount importance. If you are unsure about any of these meanings or warnings contact the Customer Care department

Please retain this instruction book for future reference, particularly if the appliance is sold or left to another person.

### Installation and service

- Any electrical installation of the cooker hood must be carried out by a qualified electrician and the hood itself must be installed by someone with experience. Installation made by an unqualified person can lead to loss of function of the cooker hood and possible damage to person and and/or property.
- The cooker hood must be at least 50 cm above electric hobs or electric ranges, or at least 65 cm above gas burners or gas ranges.
- Ensure that the power cable is not damaged during installation.
- The cooker hood is only in stand by mode unless the plug or the fuse is disconnected.
- The cooker hood cannot be connected to flues of other appliances that run on energy sources other than electricity. Please, keep to the provisions of official directives regarding fume discharge.

## Use of cooker hood

- This appliance is for domestic use only in a normal household.
- Never leave any deep-frying, melting fat, paraffin or any other inflammable liquid unattended on the hob. In the event of fire: Immediately switch off the cooker hood and the cooker. **Note! Cover the fire. Never use water.**
- Never do any flambé cooking underneath the cooker hood. It can cause a fire. Remember that overheated fat may spontaneously ignite. Never leave the frying pan unattended.
- It is essential that the grease filter is regularly cleaned to help avoid fat dripping on to the hot zone and causing a fire. Read the section on "Maintenance and Cleaning" in the instruction book.

## Disposal

- Prevent accidents when disposing of your cooker hood. Disconnect the power plug from the wall socket and cut the power cord at the hood inlet. Contact your local authority for information on where to dispose the cooker hood.

## Description of the cooker hood

### Functions

There are two possible systems:

- Extraction of air to the outside using an optional venting kit and evacuation duct.
- Recirculation using an optional carbon filter.

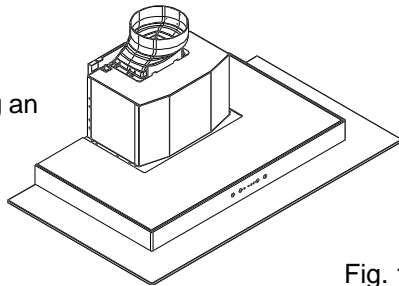

Fig. 1

### Accessories

The following are included with the cooker hood.

- 1 Adaptor 150-125 mm
- 2 Tube clamps
- 1 hood canopy complete with controls, lighting and fan motor.
- 1 telescopic chimney stack formed by: U-shaped upper section and U-shaped lower section.
- 1 reduction flange Ø 150-125 mm.
- 1 recirculation spigot.
- 1 plastic bag containing: 2 wall hooks to fix the canopy hood, 1 wall bracket to fix the chimney, rawl plugs, screws, and documentation.

The following can be ordered from your retailer:

- Carbon, KF8 filter, alternatively KFL 60/80. The carbon filter is to be used when the hood is connected to the recirculation mode.

# Using the cooker hood

## The control panel

Best results are obtained by using a low speed for normal conditions and high speed when odours are more concentrated.

Turn the hood on a few minutes before you start cooking then you will get an underpressure in the kitchen. It should be left on after cooking for about 15 minutes or until all odours have disappeared.

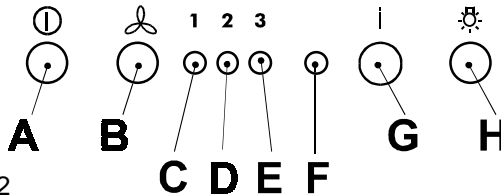

Fig. 2

- A** - Main switch, hood on/off.
- B** - Start and choice of motor speed 1-2-3-1-2.....
- C** - Indicates speed 1 (LED) and indication of the grease saturation for the filter (flashing indicator).
- D** - Indicates speed 2 (LED) and indication of the charcoal saturation for the filter (flashing indicator).
- E** - Indicates speed 3 (LED)
- F** - Indicates Intensive speed (LED).
- G** - Intensive speed on/off. The Intensive speed runs for 5 minutes:  
If the hood is on when the Intensive speed is activated, the hood reverts to previous speed after 5 minutes.  
If the hood is off when the Intensive speed is activated, the hood will be turned off after 5 minutes.  
To interrupt the Intensive speed, press button A or B.
- H** - Light ON/OFF

## Correct ventilation

If the cooker hood is to work correctly there must be an underpressure in the kitchen. It is important to keep the kitchen windows closed and have a window in an adjacent room open.

## Important to know

Not applicable for recirculation. Great care must be taken if the hood is used at the same time as a burner or fireplace (e.g. gas, diesel, coal or wood heaters, water heaters, etc.), as the hood will expel air which is required by these other appliances. Attend to it by opening a window. The negative pressure in the room must not exceed 0,04 mbar to prevent fumes being drawn back into the room by the cooker hood.

---

## **LED Indicator lights for verifying the saturation of filters**

This hood is supplied without a charcoal filter. If the hood is to be used in the recirculation mode with a charcoal filter, the saturation indicator must be activated as follows:

Depress and hold the A and B buttons simultaneously for 3 seconds. Initially only the LED indicator signal for the grease filter C is activated, shortly after the LED indicator for the charcoal filter D will activate, at this point the saturation detection has been enabled.

To switch off the saturation detection : depress and hold the A and B buttons for 3 seconds until the LED indicator for the active carbon filter is flashing.

### **Led – Indicator for grease filter C**

The LED indicator for the grease filter will flash when it requires cleaning.

Follow the maintenance instructions.

### **Led - indicator for charcoal filter D**

The LED indicator for the charcoal filter illuminates when the filter requires replacing.

This occurs after about 160 working hours from when the active carbon filter was first put into operation.

### **Resetting the saturation indicator**

After cleaning or replacing the filter depress and hold the G and H buttons again for 3 seconds until the grease filter LED or the charcoal indicator LED are no longer flashing.

# Maintenance and cleaning



Before doing any maintenance work on the hood, disconnect it from the main supply by disconnecting the plug from the wall socket or unscrewing the fuse.

## Cleaning the hood

Clean the outside of the hood using a damp cloth and a mild detergent. Never use corrosive, abrasive or flammable cleaning products.

## Cleaning the grease filters

Clean the filter every month or every other month according to how much the hood is used. The cleaner the filters, the more grease they collect. Remove the filters by (Fig. 3):

- Push the handle towards the rear of the hood.
- Pull the filter down at the front and remove it forwards.

The filter is made of aluminium wires on which the grease collects. Clean the filter in hot water using a detergent, or in a dishwasher. Let the filter dry before putting it back. Note that a dishwasher may discolour the filter.

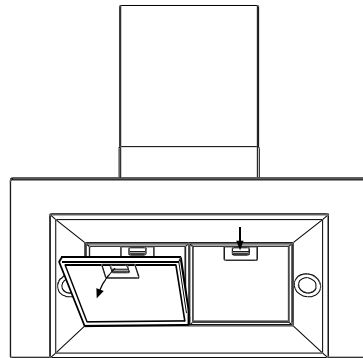

Fig. 3

## Changing and cleaning the carbon filter

Only applicable for recirculation. The carbon filters absorb smells and odours.

Unlike other carbon filters, the LONGLIFE carbon filter can be cleaned and reactivated. At normal use the filter should be cleaned every second month. The best way to clean the filter is in the dishwasher. Use normal detergent and choose the highest temperature (65° C). Wash the filter separately so that no food parts gets stuck on the filter and later causes bad odours. To reactivate the carbon, the filter should be dried in an oven for 10 minutes with a temperature of maximum 100° C.

The KFL 60/80 carbon filter can not be reactivated, it has to be changed after 6-8 months of normal use.

After approximately three years of use, the KF8 filter should be replaced with a new, as the odour reduction capacity will be reduced.

To remove the filter (Fig. 4):

- Remove the grease filters.
- Press the red buttons (A), lower the front of the carbon filter.
- Remove the carbon filter.
- Replace in reverse order.

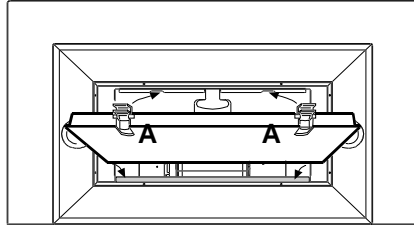

Fig. 4



Clean the filters regularly. The grease that collects in the filters and the duct could ignite if a hot plate is left on (or if overheating occurs).

## Remove the upper glass panel

The upper glass panel can be removed for cleaning (Fig. 5):

- Remove the grease filters
- Pull the handle L down
- Remove the glass panel

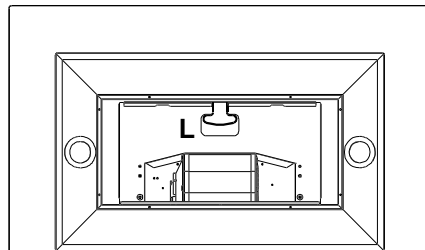

Fig. 5

## Changing the light

Disconnect the cooker hood from the main supply before changing the light.

To change the light (Fig. 6):

- Remove the lamp cover, use a screw driver.
- Replace the old bulb with a new one of the same type.
- Remount the lamp cover.

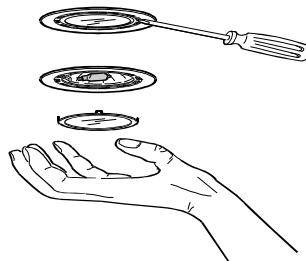

Fig. 6

# What to do if

If your appliance fails to work properly please carry out the following checks.

Symptom	Solution
The cooker hood will not start...	Check that: The hood is connected to the electricity supply. Check that the fan speed control is set to 1, 2 or 3.
The cooker hood is not working effectively..	Check that: The fan speed is set high enough for the task. The grease filters are clean. The kitchen is adequately vented to allow the entry of fresh air. If set up for recirculation, check that the charcoal filter is still effective. If set up for extraction, check that the ducting and outlets are not blocked.
The cooker hood has switched off during operation...	The safety cut-out device has been tripped. Turn off the hob and then wait for the device to reset. If the hood has been installed below the heights indicated in the installation instructions the motor will cut-out frequently which will damage the hood.

If after all these checks, the problem persists, contact your local Service Force Centre, quoting the model and serial number.

Please note that it will be necessary to provide proof of purchase for any in-guarantee service calls.

In-guarantee customers should ensure that the above checks have been made as the engineer will make a charge if the fault is not a mechanical or electrical breakdown.



---

## Service and spare parts

In the event of your appliance requiring service, or if you wish to purchase spare parts, contact your local AEG Service Force Centre by telephoning

**08705 929 929**

Your call will be automatically routed to the Service Centre covering your post code area.

For the address of your local Service Force Centre and further information about Service Force, please visit the website at [www.serviceforce.co.uk](http://www.serviceforce.co.uk)

Please ensure that you have read the section „What to do if...“ as the engineer will make a charge if the fault is not a mechanical or electrical breakdown even the appliance is under warranty.

**Please note that proof of purchase is required for in-guarantee service calls.**

### Help us to help you

Please determine your type of enquiry before writing or telephoning.

When you contact us we need to know:

- Your name
- Address and post code
- Telephone number
- Clear and concise details of the fault
- Name and model of the appliance\*
- E number\*

\* This information can be found on the rating plate, which can be seen when the grease filters are removed.

## Customer Care

For general enquiries concerning your AEG appliances, or for further information on AEG products, please contact our Customer Care Department at the address below or visit our website at [www.aeg.co.uk](http://www.aeg.co.uk)

Customer Care Department  
AEG Domestic Appliances  
55-77 High Street  
Slough  
Berkshire  
SL1 1DZ  
Tel.: 08705 350 350\*

\* calls to this number may be recorded for training purposes.

# Guarantee conditions

## Guarantee Conditions

AEG offer the following guarantee to the first purchaser of this appliance.

1. The guarantee is valid for 12 months commencing when the appliance is handed over to the first retail purchaser, which must be verified by purchase invoice or similar documentation. The guarantee does not cover commercial use.
2. The guarantee covers all parts or components which fail due to faulty workmanship or faulty materials. The guarantee does not cover appliances where defects or poor performance are due to misuse, accidental damage, neglect, faulty installation, unauthorised modification or attempted repair, commercial use or failure to observe requirements and recommendations set out in the instruction book. This guarantee does not cover such parts as light bulbs, removable glass-ware or plastic.
3. Should guarantee repairs be necessary the purchaser must inform the nearest customer service office (manufacturer`s service or authorised agent). AEG reserves the right to stipulate the place of the repair (i.e.the customer`s home, place of installation or AEG workshop).
4. The guarantee or free replacement includes both labour and materials.
5. Repairs carried out under guarantee do not extend the guarantee period for the appliance. Parts removed during guarantee repairs become the property of AEG.
6. The purchaser`s statutory rights are not affected by this guarantee.

## European Guarantee

If you should move to another country within Europe then your guarantee moves with you to your new home subject to the following qualifications:

- The guarantee starts from the date you first purchased your product.
- The guarantee is for the same period and to the same extent for labour and parts as exist in the new country of use for this brand or range of products.
- This guarantee relates to you and cannot be transferred to another user.
- Your new home is within the European Community (EC) or European Free Trade Area.
- The product is installed and used in accordance with our instructions and is only used domestically, i.e. a normal household.
- The product is installed taking into account regulations in your new country.

Before you move please contact your nearest Customer Care Centre, listed below, to give them details of your new home. They will then ensure that the local Service Organisation is aware of your move and able to look after you and your appliances.

France	Senlis	+33 (0) 3 44 62 29 29
Germany	Nürnberg	+49 (0) 800 234 7378
Italy	Pordenone	+39 (0) 800 117 511
Sweden	Stockholm	+46 (0) 8 672 5360
UK	Slough	+44 (0) 1753 219899

## Technical data

### Model

**2600 D**

Size	Height	800-1225 mm
	Width	898 mm
	Depth	520 mm
Light		Max 2X20 W
Grease filter		2 pcs.
Voltage		220-240 V
Total power		175 W
Fuse Rating		13 Amp

### Extra accessories:

Carbon filter KF 8 (LONGLIFE)  
Carbon filter KFL 60/80

P-nr. 942 118 609  
610 899 421

# Installation

## Unpacking

Check that the cooker hood is not damaged. Transportation damages should immediately be reported to the transport company. Damages, faults and missing parts should immediately be reported to the retailer.

Dispose carefully of the packaging material so that it is out of the way of small children.

## Position

The cooker hood should be mounted freely hanging on the wall. The  
cooker

hood must be at least 50 cm above electric hobs or electric ranges, or at least 65 cm above gas burners or gas ranges.

---



The cooker hood cannot be connected to flues of other appliances that run on energy sources other than electricity. Please, keep to the provisions of official directives regarding fume discharge.

---

## Electrical connection

The electric outlet should be placed inside the chimney. The hood has a power cable, 100 cm, with earth connection and the rated voltage is 220 - 240 V.

Connect the hood to the mains supply via a double pole switch which has 3 mm minimum clearance between the contacts 220-240 V.

The following is valid in the United Kingdom only:

As the colours of the wires in the mains lead of this appliance may not correspond with the coloured markings identifying the terminals in your plug, proceed as follows:

- the wire which is coloured green and yellow must be connected to the terminal in the plug which is marked with the letter E or by the earth symbol (  $\perp$  ), or coloured green or green and yellow;
- the wire which is coloured blue must be connected to the terminal which is marked with the letter N or coloured black, -
- the wire which is coloured brown must be connected to the terminal which is marked with the letter L or coloured red.

## Mounting the cooker hood - Fig. 8

- Position the template (1) on the wall and mark the position, and drill the holes (2 x Ø 8 mm). Mount the two rawl plugs with the hooks (3)
- Hang the hood on the hooks and level it with the adjustment screws (4)
- Remove the grease filters (5) and mark for the two screws (6). Remove the hood and drill the holes (2 x Ø 8 mm).
- Insert the rawl plugs (7) and hang the hood on the wall again. Adjust it horizontally with the screws (8) and secure it with the screws (9)
- Mount the chimney holder (10) with the rawl plugs (9a) and the screws (11).

Be careful that it is centered over the hood and horizontally aligned.

## Fitting for ducting (S)

Connect a tube between the hood air outlet and the wall or roof exhaust channel. Fix it with the tube clamps supplied.

## Fitting for recirculation

Mount the recirculation spigot (12) with the two screws (13) supplied.

## Mounting the chimney

- Place the chimney and fix it to the top chimney holder with the two screws (16) supplied.
- Lower the bottom part of the chimney and fasten it to the top of the hood with two screws (17), supplied.

**Note** that the top part of the chimney can be mounted with the side grids up or down. For use as a recirculation hood it must be mounted with the grids upwards. (Fig. 7).

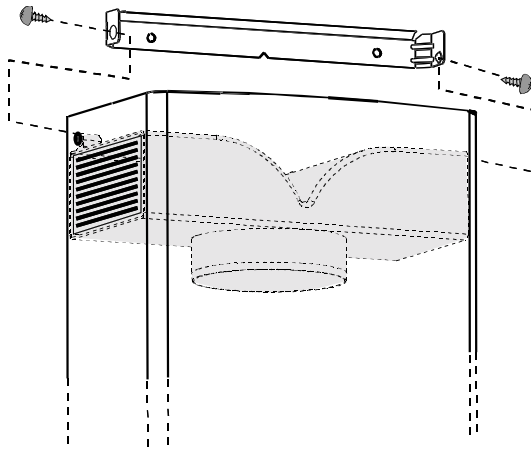

Fig. 7

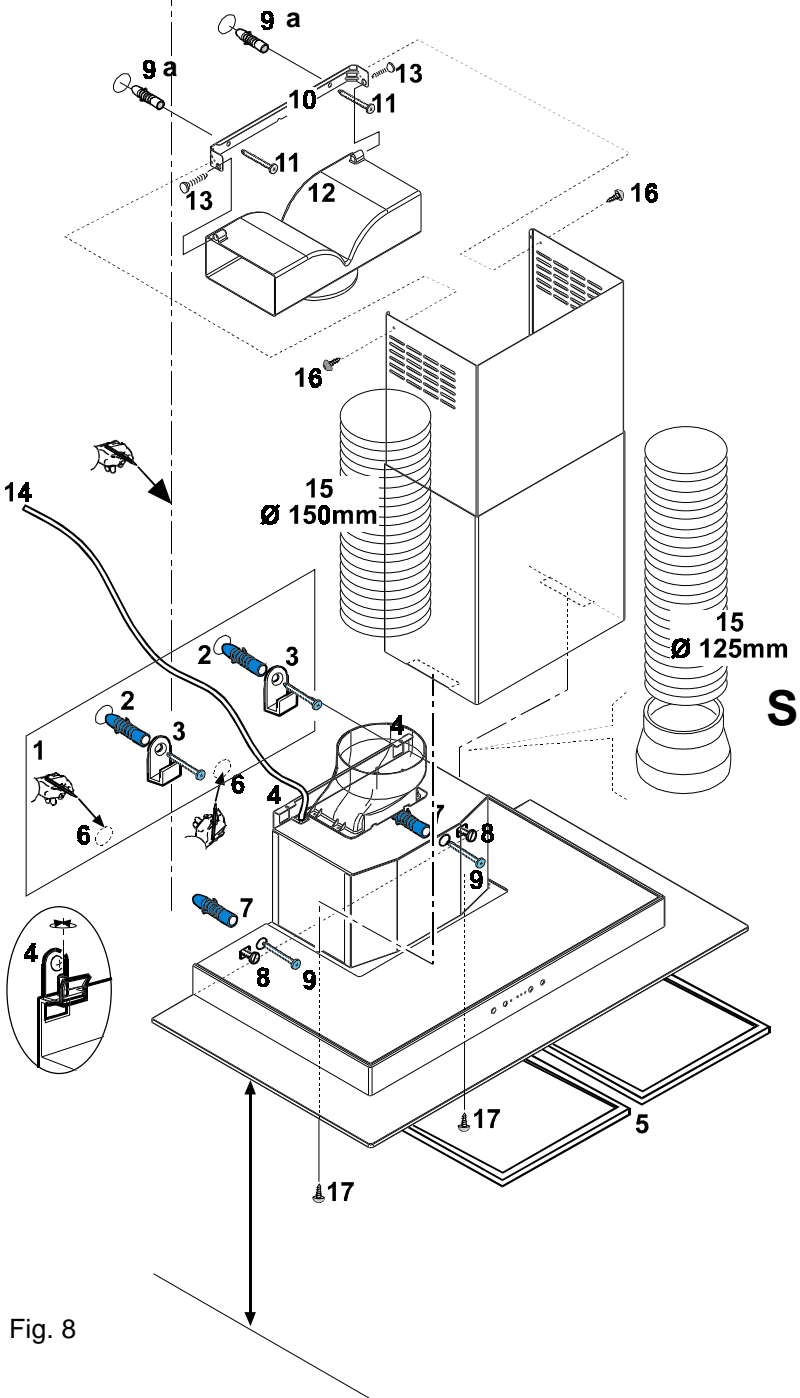

Fig. 8

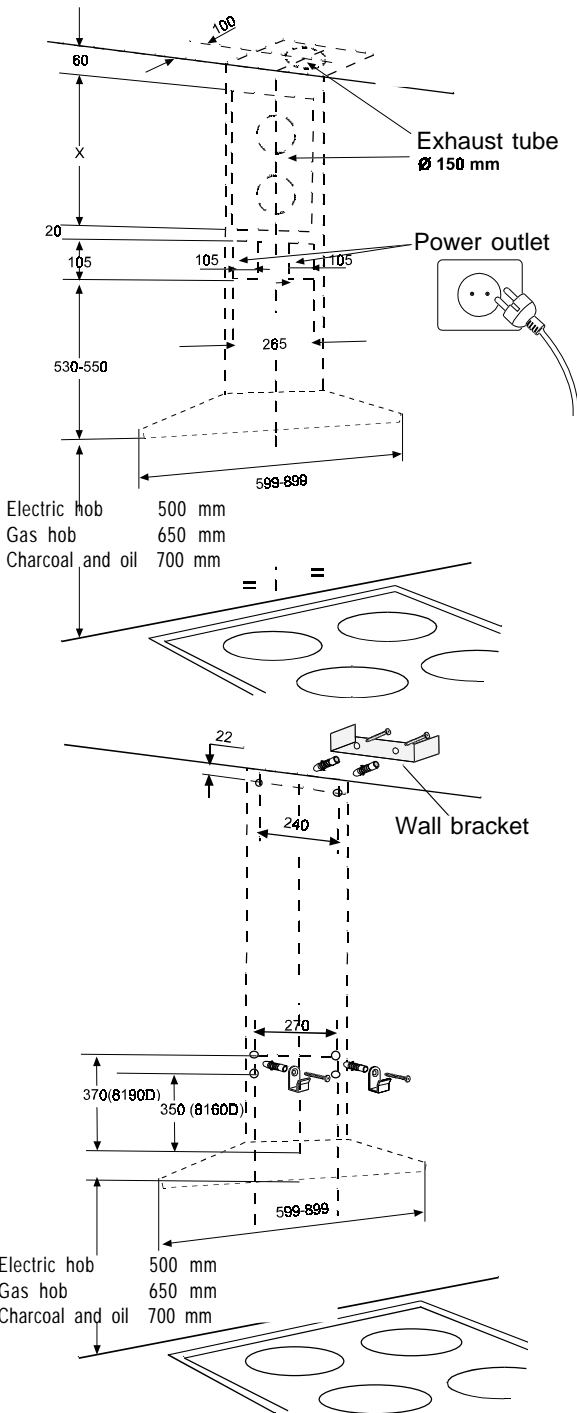

Fig. 8a

**AEG Hausgeräte GmbH**  
**Postfach 1036**  
**D-90327 Nürnberg**

**<http://www.aeg.hausgeraete.de>**

**© Copyright by AEG**

**LI1LLD Ed. 05/02**